



Design Guide for **Hospitality Lighting**



**Design Guide for
Hospitality Lighting**

Publication of this Design Guide
has been approved by the IES.
Suggestions for revisions should
be directed to the IES

Copyright 2017 by the Illuminating Engineering Society.

Approved by the IES Standards Committee, June 16, 2017, as a Transaction of the Illuminating Engineering Society.

All rights reserved. No part of this publication may be reproduced in any form, in any electronic retrieval system or otherwise, without prior written permission of the IES.

Published by the Illuminating Engineering Society, 120 Wall Street, New York, New York 10005.

IES Standards and Guides are developed through committee consensus and produced by the IES Office in New York. Careful attention is given to style and accuracy. If any errors are noted in this document, please forward them to the Director of Standards and Research, bliebel@ies.org, at the above address for verification and correction. The IES welcomes and urges feedback and comments.

ISBN# 978-0-87995-360-7

Printed in the United States of America.

DISCLAIMER

IES publications are developed through the consensus standards development process approved by the American National Standards Institute. This process brings together volunteers representing varied viewpoints and interests to achieve consensus on lighting recommendations. While the IES administers the process and establishes policies and procedures to promote fairness in the development of consensus, it makes no guaranty or warranty as to the accuracy or completeness of any information published herein.

The IES disclaims liability for any injury to persons or property or other damages of any nature whatsoever, whether special, indirect, consequential or compensatory, directly or indirectly resulting from the publication, use of, or reliance on this document

In issuing and making this document available, the IES is not undertaking to render professional or other services for or on behalf of any person or entity. Nor is the IES undertaking to perform any duty owed by any person or entity to someone else. Anyone using this document should rely on his or her own independent judgment or, as appropriate, seek the advice of a competent professional in determining the exercise of reasonable care in any given circumstances.

The IES has no power, nor does it undertake, to police or enforce compliance with the contents of this document. Nor does the IES list, certify, test or inspect products, designs, or installations for compliance with this document. Any certification or statement of compliance with the requirements of this document shall not be attributable to the IES and is solely the responsibility of the certifier or maker of the statement.

Prepared by the IES Hospitality Lighting Committee

Emlyn Altman, *Chair*
Don King, *Vice-Chair*
Neeraj Lal, *Secretary*

S. Agosta-Bidleman*	C. Israel	M. Strong*
N. Bleeker	J. Krauza*	R. Valdes*
A. Foust*	N. Lesniak*	Carrie Verkuil*
J. Fox	Y. Li Toh*	J. Wratten*
K.Geil*	A. Luong	F. Zaino*
D. Ghatan	S. Parish	G. Zbrizher
T. Horitani*	S. Pay	
J. Hudock*	A. Ruedaflores*	* Advisory
M. Hudson*	T. Scott*	
P. Hugh	A. Spata*	

Cover image of the Atlantis Hotel Lobby – photo courtesy of Emlyn Altman & Studio Lux

Please refer to the IES Bookstore after you purchase this IES Standard, for possible
Errata, Addenda, and Clarifications, www.ies.org/bookstore

Please refer to ANSI/IES RP-16-17 Nomenclature and Definitions,
www.ies.org/standards/ansi-ies-rp-16/

Contents

FOREWORD	1
1.0 INTRODUCTION	1
1.1 Key Elements of the Design Guide	2
1.2 Hospitality Segments	2
2.0 LIGHT SOURCES AND CONTROLS	2
2.1 Light Sources	2
2.2 Lighting Controls	3
2.2.1 Local Control Systems	3
2.2.2 Centralized Control Systems	4
2.3 Design Considerations	5
3.0 CODE COMPLIANCE	7
3.1 Code Requirements for Luminaire Energy Efficiency	7
3.2 Safety agency listing	8
3.3 Safety and Security with Track Lighting	8
3.3.1 Track Lighting	8
3.3.2 Track Lighting Systems	8
3.3.3 Codes and Safety Requirements for Track Lighting Systems	8
4.0 EXTERIOR ENTRANCE AND ENTRY DRIVE	9
4.1 Lighting Design Considerations	10
4.2 Design Criteria and Solutions	10
5.0 LOBBY	11
5.1 Lighting Design Considerations	11
5.2 Design Criteria and Solutions	12
6.0 ELEVATOR LOBBIES	15
7.0 PUBLIC CORRIDORS	16
8.0 PUBLIC RESTROOMS	17
9.0 EMERGENCY LIGHTING	17
9.1 Lighting Design Considerations	18
9.2 Design Criteria and Solutions	18
10.0 BALLROOMS AND MULTIFUNCTION MEETING ROOMS	19
10.1 Ballrooms	19
10.1.1 Lighting Design Considerations	19

10.1.2 Design Criteria and Solutions	19
10.2 Multifunction Meeting Rooms	21
10.2.1 Lighting Design Considerations	21
10.2.2 Design Criteria and Solutions	21
11.0 EXHIBITION HALLS	23
11.1 Lighting Design Considerations	23
11.2 Design Criteria and Solutions	24
12.0 FOOD AND BEVERAGE	24
12.1 Lighting Design Considerations	24
12.2 Design Criteria and Solutions	24
13.0 RETAIL	26
13.1 Lighting Design Considerations	26
13.2 Design Criteria and Solutions	28
14.0 BUSINESS CENTER	29
14.1 Lighting Design Considerations	29
14.2 Design Criteria and Solutions	29
15.0 SPA SERVICES	29
15.1 Lighting Design Considerations	30
15.2 Design Criteria and Solutions	31
15.2.1 Spa Lobby	32
15.2.2 Spa Treatment Rooms	32
15.2.3 Spa Lockers	32
15.2.4 Spa Makeup and Cosmetics	32
16.0 FITNESS CENTER	32
16.1 Lighting Design Considerations	33
16.2 Design Criteria and Solutions	33
17.0 GUEST CORRIDORS	34
17.1 Lighting Design Considerations	34
17.2 Design Criteria and Solutions	34
18.0 GUEST ROOMS	35
18.1 Lighting Design Considerations	36
18.2 Design Criteria and Solutions	36
19.0 GUEST BATHROOMS	38
19.1 Lighting Design Considerations	38
19.2 Design Criteria and Solutions	38
ANNEX A – ILLUMINANCE DETERMINATION PROCEDURE	40
ANNEX B – ILLUMINANCE RECOMMENDATIONS: INTRODUCTION	44

ANNEX C – ILLUMINANCE RECOMMENDATIONS FOR COMMON APPLICATIONS	57
ANNEX D – COLOR CONSIDERATIONS	72
ANNEX E – ENERGY MANAGEMENT CONSIDERATIONS.....	73
ANNEX F – AMERICANS WITH DISABILITIES ACT (A.D.A.) CONSIDERATIONS (U.S.)	76
ANNEX G – EXTERIOR WALKWAYS AND BIKEWAYS.....	78
ANNEX H – BACKLIGHT, UPLIGHT, AND GLARE (BUG) RATINGS.....	84
REFERENCES	85

FOREWORD

This Design Guide has been developed to aid designers, facility managers, and owners in creating lighting systems for hotel applications. The intent is to address how all of the various components of hospitality lighting need to be an integrated system of layers as well as uniquely represented areas of illumination.

Lighting is critical to commercial success in the hospitality industry. Lighting is often the first feature that guests notice (see **Figures 1, 2**) and is the element that creates that all-important long-lasting positive impression. This first impression may form guests' opinions about the quality, character, convenience, and charm of the hotel even before they reach the front entrance.

This process of evaluation begins when the hotel is first seen from the street. During the day, it is based on the hotel's architecture and the surrounding area. At night, it is largely based on the way exterior lighting accents the building. Well-designed outdoor lighting identifies the hotel and its entrance and welcomes guests. It also reinforces a feeling of

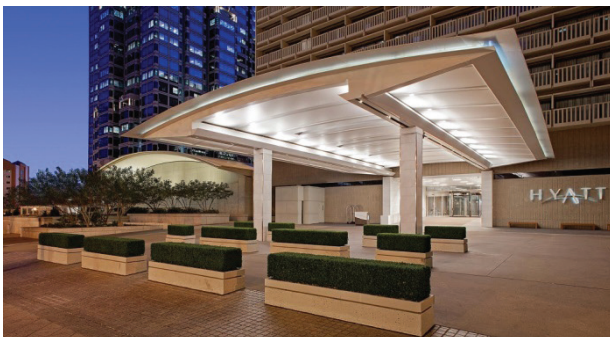

Figure 1. Bright porte cochere lighting announces building entry and provides a sense of arrival.

(Photo courtesy of Peter Hugh)



Figure 2. Lighting reinforces building's identity and enhances architectural features.

(Photo courtesy of Lighting Design Alliance)

safety and security, and provides a first glimpse of the hotel's interior character and style.

Once indoors, proper lighting is essential in making sure the guests' impressions continue to be positive. This same principle continues as the guests walk down the corridors, visit their rooms, and have their first meal. Creative and effective lighting in restaurants, bars, and shops attracts more patrons, increases sales, and contributes to revenue growth.

Quality lighting is of the utmost importance to business travelers who work in their rooms and/or in the hotel's conference facilities. Effective, well designed lighting will make their stay pleasurable and productive, entice them to return, and provide positive word of mouth references, which are excellent advertising. All these factors reinforce the brand and are critical to the success of the property.

In addition to the guest benefits, good lighting also helps the staff work more efficiently and effectively and perform their tasks safely. Here again, lighting can improve productivity and increase the hotel's profitability. Lighting controls add convenience and reduce energy use and operating costs. Light source and power supply, and luminaire efficiency, placement, and optical performance all affect operating and maintenance costs.

1.0 INTRODUCTION

Addressing every lighting issue of the hospitality industry would require a broader format than available here. Therefore, this Design Guide focuses on key areas in hotels and provides recommendations for the technologies and application designs available at the time it was written.

It is important to recognize that all documents are works in progress. While the main objective of lighting design is to serve human needs, and enhance the human experience with high quality lighting, ways to achieve the objective are constantly evolving. Lighting technologies are continually changing. Effective energy utilization and sustainability issues become increasingly important considerations that alter design parameters. Daylighting and controls are becoming increasingly more integrated and complex. Design styles, trends, and the degree of public sophistication continue to evolve, resulting in changes to the way lighting systems are designed.